

58 Hawthorn Road, Manchester M40 3RJ

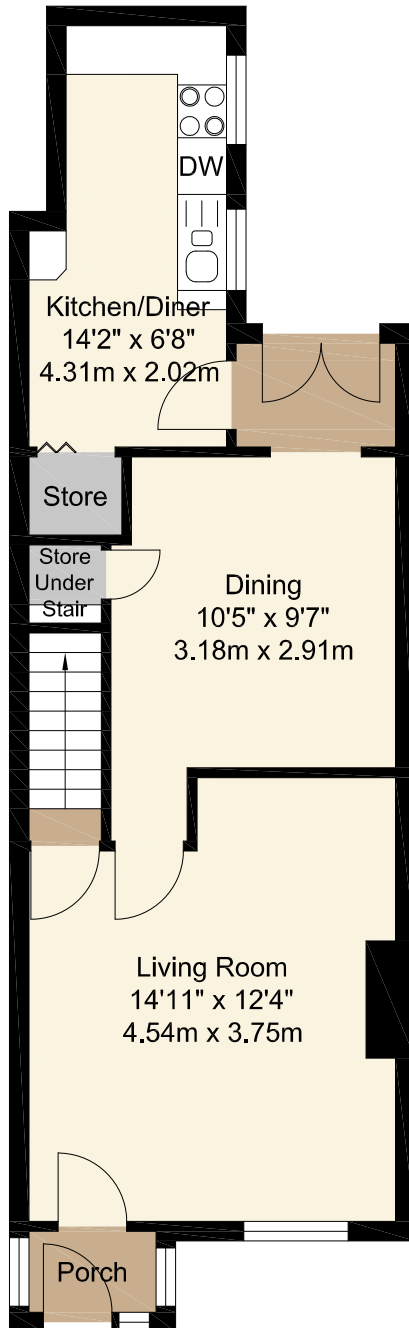

Ground Floor
Approximate Floor Area
437.55 SQ.FT.
(40.65 SQ.M.)

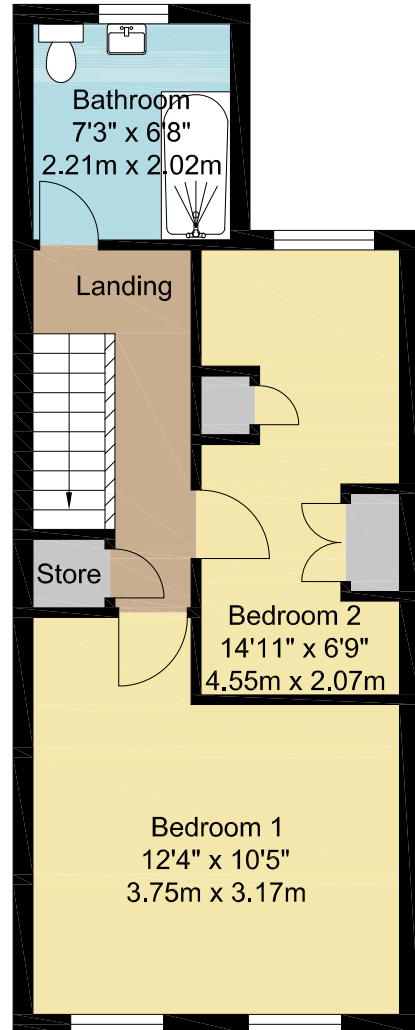

First Floor
Approximate Floor Area
365.86 SQ.FT.
(33.99 SQ.M.)

TOTAL APPROX FLOOR AREA 803.41 SQ.FT. (74.64 SQ. M.)

Whilst every attempt has been made to ensure the accuracy of the floor plan contained here, measurements of doors, windows, rooms and any other items are approximate and no responsibility is taken for any error, omission or misstatement. This plan is for illustrative purposes only and should be used as such by any prospective purchaser.