

**noir**

by david cliff



Beautifully created

Sandy Lane | Wokingham

£1,195,000

# noir

## Beautifully created

This home has been totally transformed into what is now a truly versatile and quite stunning family home.

The current owners have created something quite special and you really do need to walk inside here to fully appreciate what is on offer. The secluded setting in Sandy Lane is one that many are still not aware of, a hidden gem of a road. The approach here itself sets the scene well, you have your own space and privacy to the rear giving a wonderful rural feel too, not to mention some fantastic woodland walks.

On arrival the vast sweeping gravel drive allows parking for numerous vehicles so you, your guests and children of a driving age that come and go with their friends will all be accommodated. You also then have a large lawn area which softens things nicely and really gives the frontage you would want in a home of this level.

So moving inside I'll give you an overview on what has been created here as words really won't do it justice, scroll through the pictures too and you'll have some idea of how impressive this is and then let's arrange a personal tour.

The entrance hall is as you would want and expect in a family home, room to get inside, get the shoes and coats off or greet your guests, the herringbone style floor is stunning by the way and continues in to the

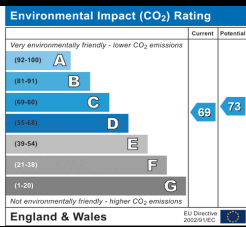
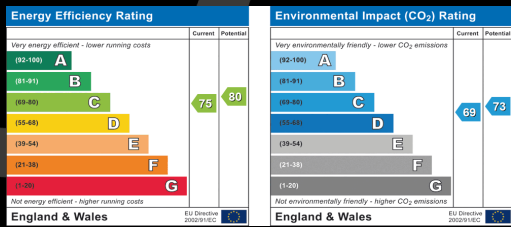

# Sandy Lane, Wokingham, RG41

APPROX. GROSS INTERNAL FLOOR AREA 3068 SQ FT 285 SQ METRES (EXCLUDES RESTRICTED HEAD HEIGHT / INCLUDES GARAGE)

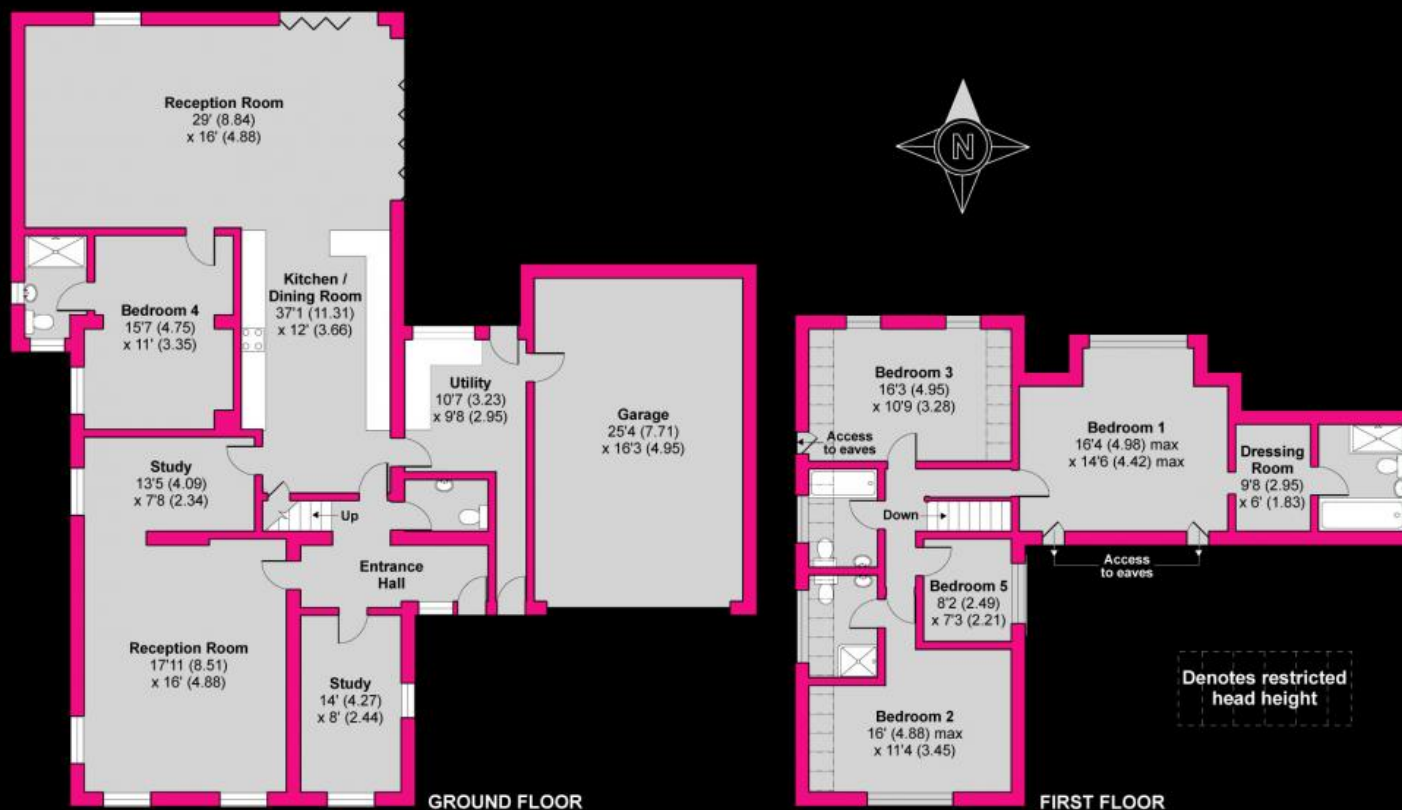

Whilst every attempt has been made to ensure the accuracy of the floor plan contained here, measurements of doors, windows and rooms are approximate and no responsibility is taken for any error, omission or misstatement. These plans are for representation purposes only as defined by RICS Code of Measuring Practice and should be used as such by any prospective purchaser. Specifically no guarantee is given on the total square footage of the property if quoted on this plan. Any figure given is for initial guidance only and should not be relied on as a basis of valuation.

Copyright nichecom.co.uk 2019 Produced for Noir Residential REF : 507959

So what is **noir**?

**GRAND, Interesting, chic** or **UNIQUE**... some properties are just a little different to the norm and we believe that requires some different marketing, so the **noir** brand was formed here at **david cliff**.

Buyers now recognise this property selection and appreciate that it is not based on price or size alone but character, charm and individuality.

[davidcliff.com](http://davidcliff.com)

**Important - please read.**

These particulars do not constitute any part of an offer or contract. All statements in these details are made without liability on the part of David Cliff Estate Agents or the seller. They should not be relied upon as a statement or representation of fact and, although believed to be correct, are not guaranteed and form no part of an offer or contract. Any intending buyers must satisfy themselves as to their correctness. Please note that all appliances and heating systems are not tested by David Cliff Estate Agents and therefore no warranties can be given as to their good working order.

Want to view this property?

Phone us on

**0118 989 9770**

**davidcliff**  
passionate about property