

10 Walmersley Road, New Moston, Manchester M40 9RS

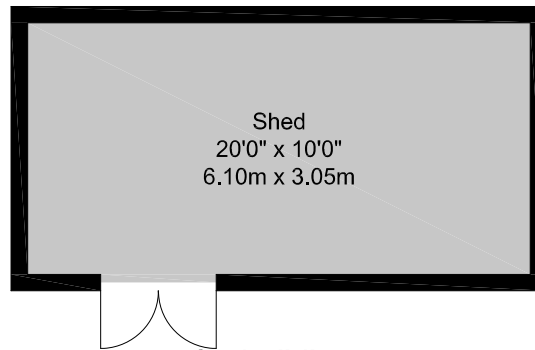

Outbuildings
Approximate Floor Area
359.94 SQ.FT.
(33.44 SQ.M.)

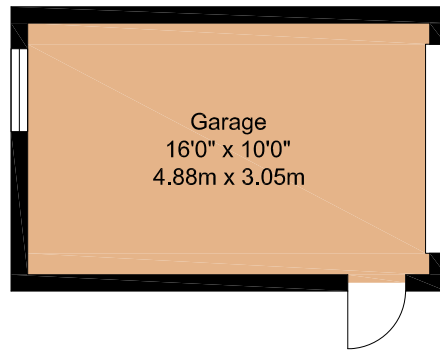
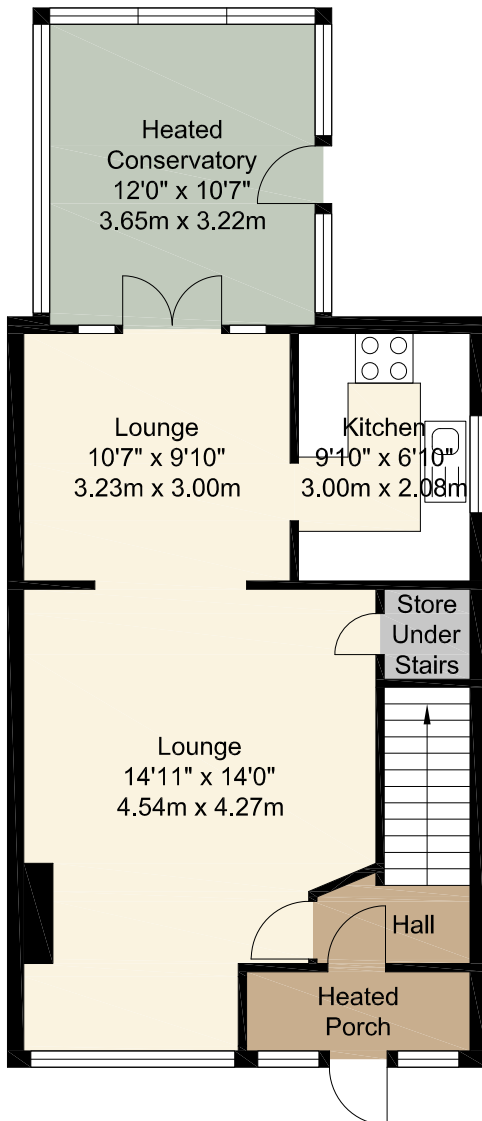

Ground Floor
Approximate Floor Area
636.57 SQ.FT.
(59.14 SQ.M.)

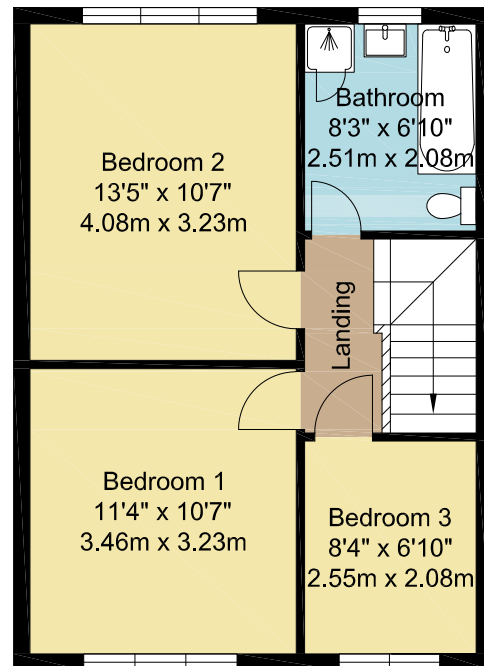

First Floor
Approximate Floor Area
444.87 SQ.FT.
(41.33 SQ.M.)

TOTAL APPROX FLOOR AREA 1441.39 SQ.FT. (133.91 SQ. M.)

Whilst every attempt has been made to ensure the accuracy of the floor plan contained here, measurements of doors, windows, rooms and any other items are approximate and no responsibility is taken for any error, omission or misstatement. This plan is for illustrative purposes only and should be used as such by any prospective purchaser.