

# 380 WELLSWAY, BATH

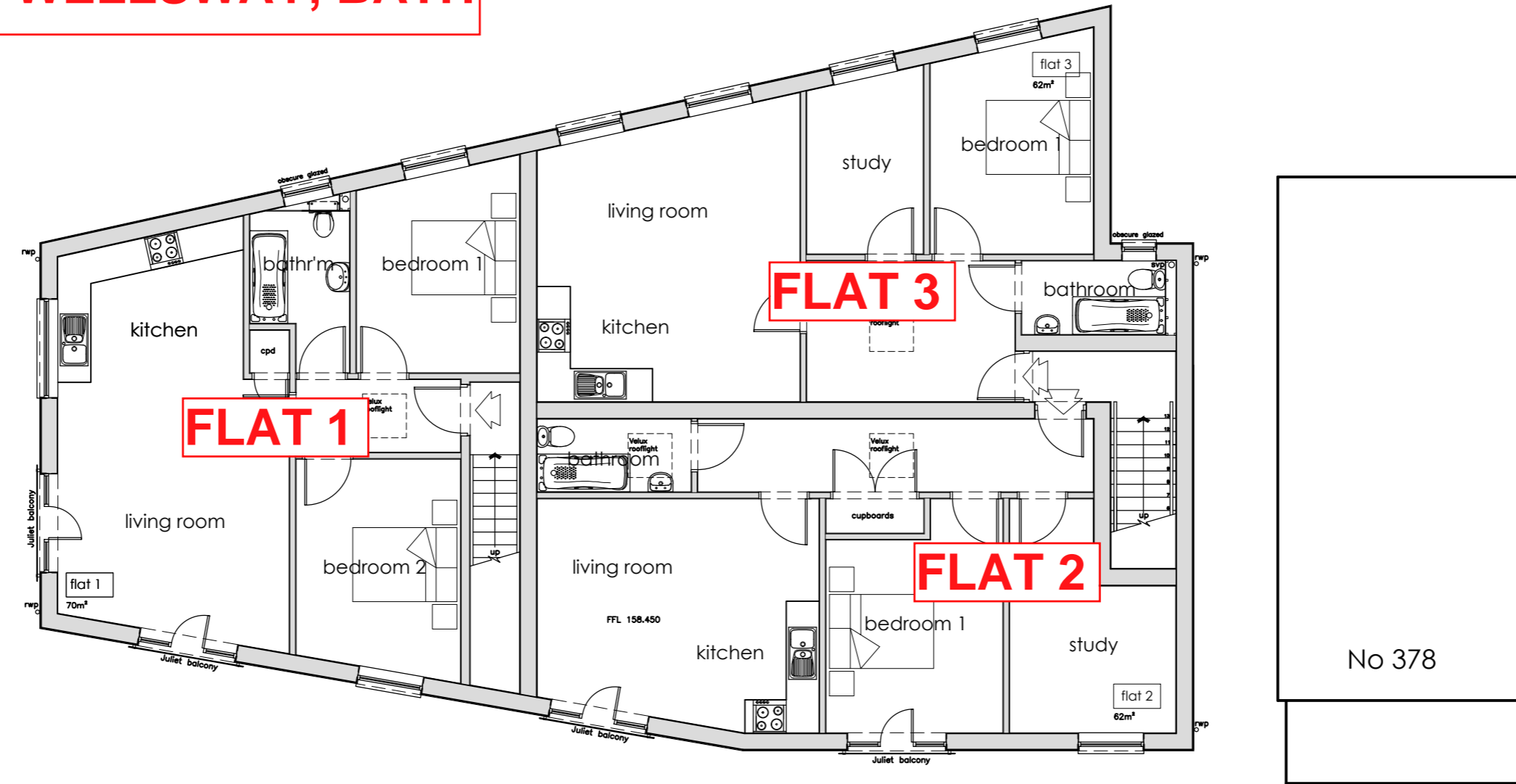

**proposed first floor plan 1:100**

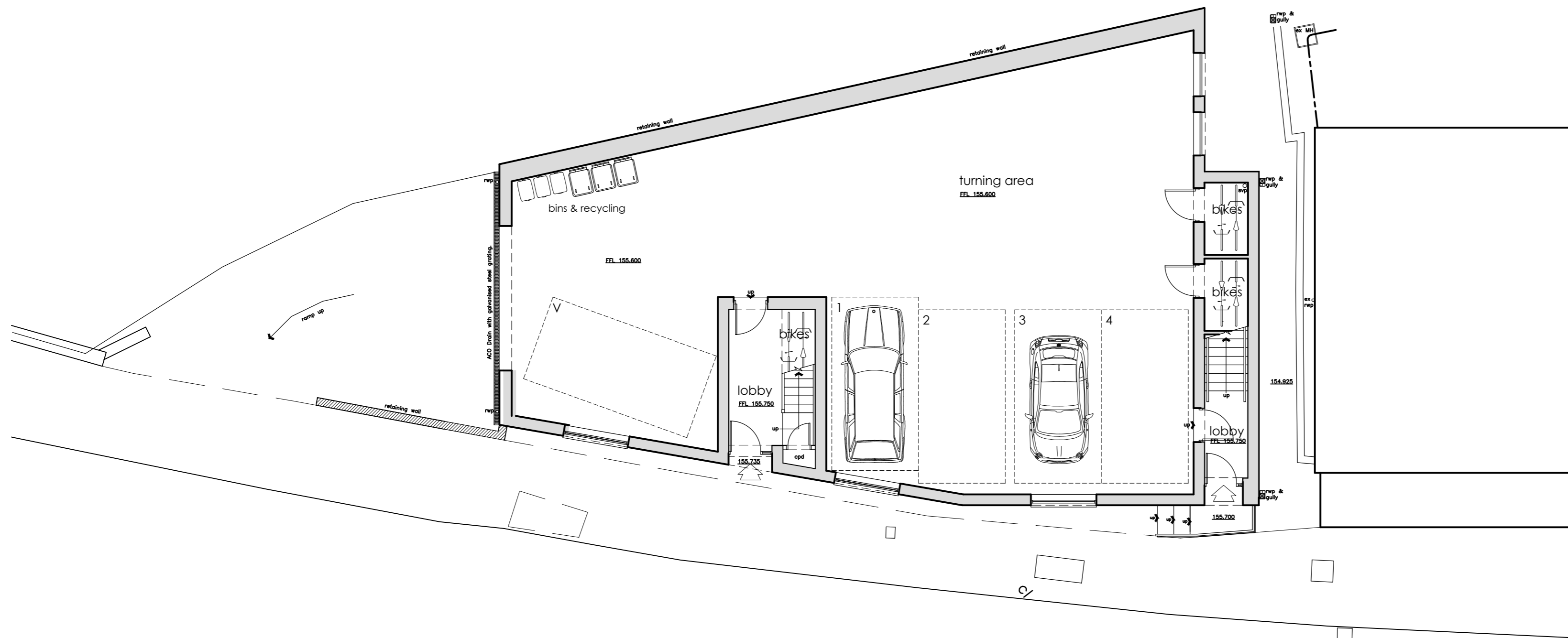

**proposed ground floor plan 1:100**



**IMPORTANT : THIS DRAWING IS NOT TO BE USED FOR CONSTRUCTION UNLESS SIGNED AND STAMPED SITE ISSUE.**

- NOTES**
1. The Contractor is to check and verify all building and site dimensions, levels, services and sewer invert levels at connection points before work commences.
  2. Use only figured dimensions and any discrepancies to be reported immediately to the Consultants.
  3. This drawing must be read with and checked against any structural or other specialist drawings.
  4. The Contractor is to comply in all respects with the current Building Regulations and relevant British Standards / Codes of Practice whether specifically stated on this drawing or not.
  5. Use of this drawing does not absolve the client from his responsibilities under Health and Safety: Construction (Design and Management) Regulations 2015.

**Planning & Design**

M.L. Planning & Design  
 24a Darstey Road, Shirehampton  
 Bristol, BS11 9XB  
 Tel: 0117 3827357  
 EMAIL: m\_lawford@hotmail.com

**CLIENT**  
 BA2 5RN Ltd  
 Cloudberry House  
 Perrymead  
 Bath  
 BA2 5AX

**PROJECT**  
 Proposed Redevelopment of;  
 Land South of 378 Wellsway  
 Bath  
 BA2 5RN  
 Proposed Floor Plans

<b>SCALE</b> 1:100 @ A2	<b>DATE</b> JANUARY 2022	
<b>Drawing No:</b> 20/010	<b>SHEET</b> 100	<b>REVISION</b>

This drawing is copyright © of M. L. Planning & Design Ltd and must not be reproduced in whole or in part without written permission.